

Draw an arc of a given radius tangent to two nonparallel lines

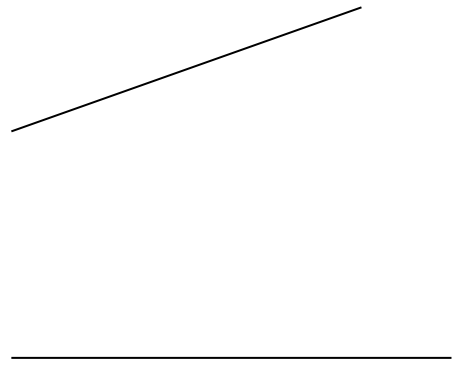

5

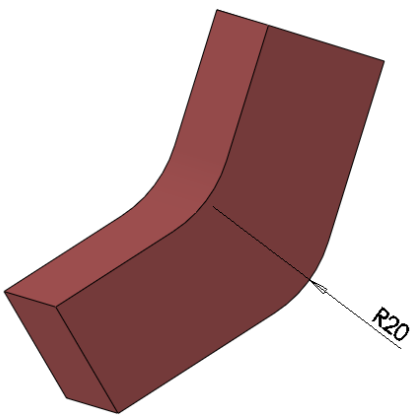

Draw an arc of a given radius tangent to two nonparallel lines

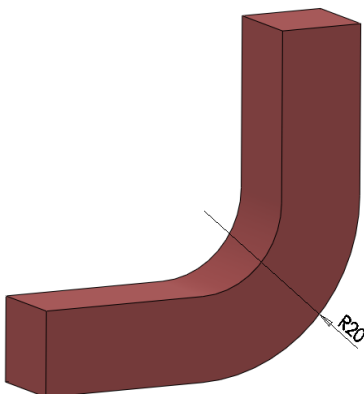
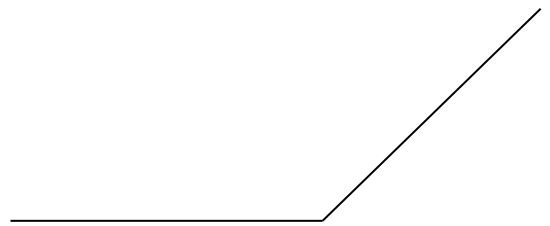

Draw an arc of a given radius tangent to two perpendicular lines



Drawn by		ENGINEERING GRAPHICS	UNIVERSITY OF GAZIANTEP	
Date			MECH. ENG. DEPT.	
Control			Drawing No	
Scale				